

ISOMETRIC VIEW

769 SQ. FT

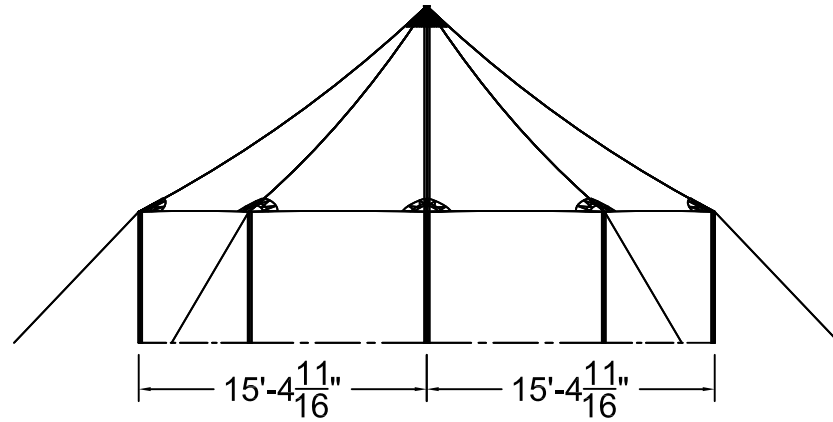

SIDE VIEW

32'W x 30'L TIDEWATER SAIL CLOTH POLE TENT

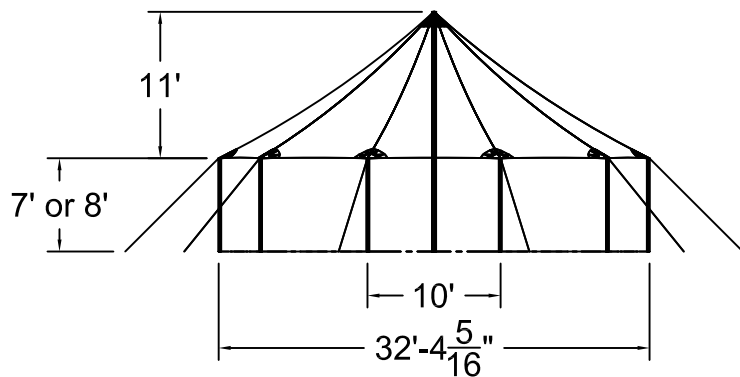

32'W TW FRONT END

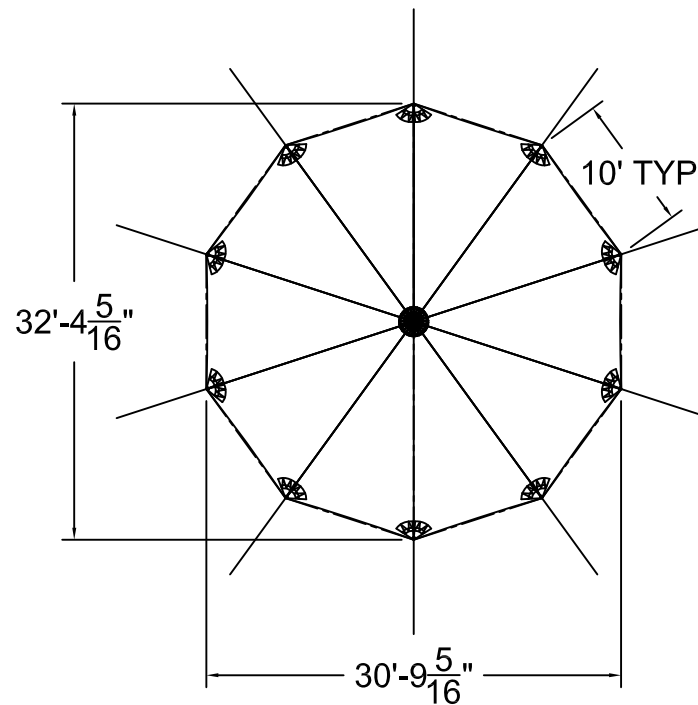

TOP VIEW

ALL DATA AND INFORMATION CONTAINED IN OR DISCLOSED BY THIS DOCUMENT IS CONFIDENTIAL AND PROPRIETARY INFORMATION OF AZTEC TENTS AND ALL RIGHTS THEREIN ARE EXPRESSLY RESERVED. BY ACCEPTING THIS MATERIAL THE RECIPIENT AGREES THAT THIS MATERIAL AND INFORMATION CONTAINED THEREIN IS HELD IN CONFIDENCE AND IN TRUST AND WILL NOT BE COPIED, REPRODUCED WHOLE OR IN PART NOR ITS CONTENTS REVEALED IN ANY MANNER TO OTHERS, EXCEPT TO MEET THE SPECIFIC PURPOSE FOR WHICH IT WAS DELIVERED.

AZTEC TENTS
DESIGN & PRODUCTION
2685 COLUMBIA ST. TORRANCE, CA. 90503
(800) 228-3687 - FAX (310) 381-0722

TIDEWATER POLE TENT
32'W x 30'L
TIDEWATER SAIL CLOTH POLE TENT
PART NUMBER: ZXXXXXX

REVISION HISTORY			
REV.	DESCRIPTION	BY:	DATE:
PROPRIETARY			
ENGINEER: N/A		DATE: 12/05/2024	
PAGE: 1 OF 1		DRAWN: M.CARDENAS	

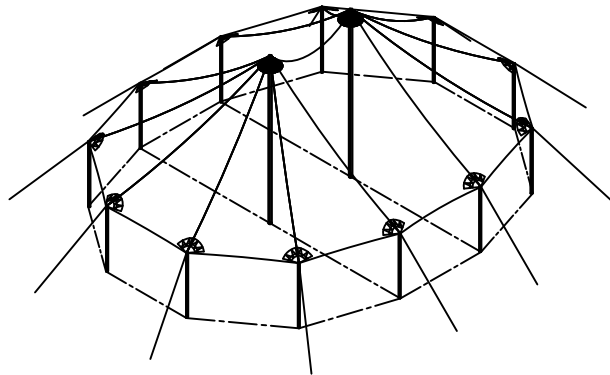

ISOMETRIC VIEW
1093 SQ. FT

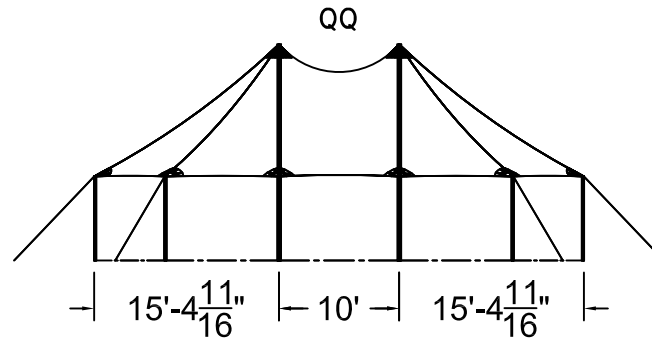

SIDE VIEW

32'W x 40'L TIDEWATER SAIL CLOTH POLE TENT

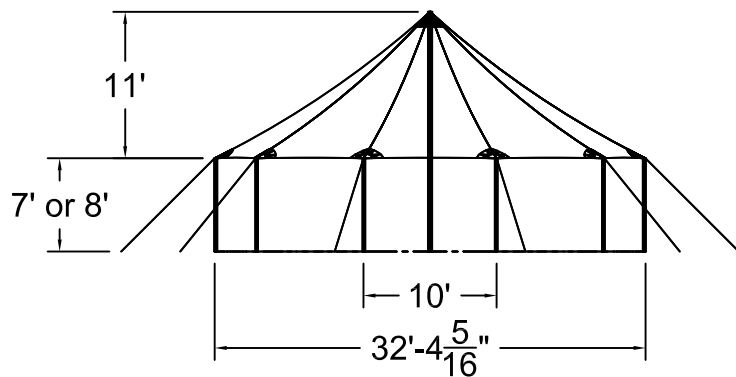

32'W TW FRONT END

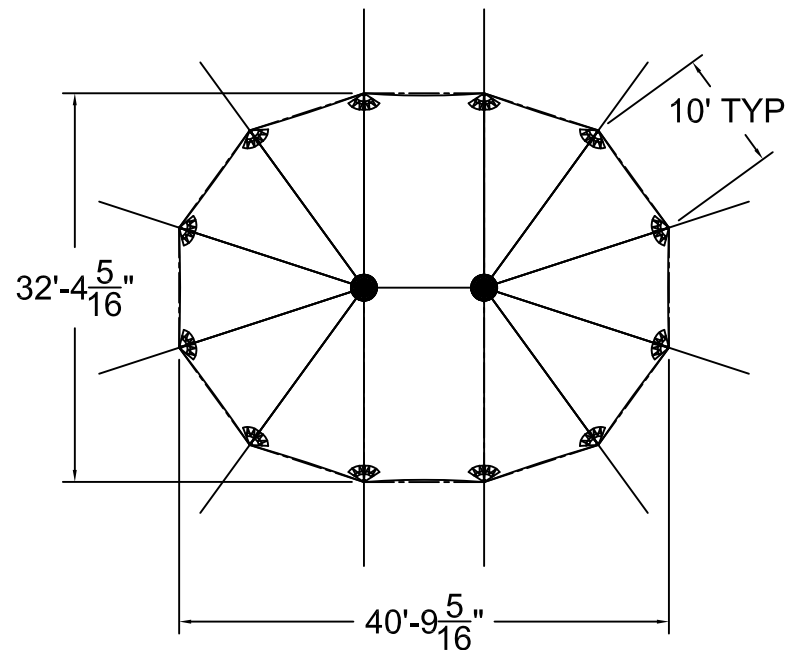

TOP VIEW

ALL DATA AND INFORMATION CONTAINED IN OR DISCLOSED BY THIS DOCUMENT IS CONFIDENTIAL AND PROPRIETARY INFORMATION OF AZTEC TENTS AND ALL RIGHTS THEREIN ARE EXPRESSLY RESERVED. BY ACCEPTING THIS MATERIAL THE RECIPIENT AGREES THAT THIS MATERIAL AND INFORMATION CONTAINED THEREIN IS HELD IN CONFIDENCE AND IN TRUST AND WILL NOT BE COPIED, REPRODUCED WHOLE OR IN PART, NOR ITS CONTENTS REVEALED IN ANY MANNER TO OTHERS, EXCEPT TO MEET THE SPECIFIC PURPOSE FOR WHICH IT WAS DELIVERED.

AZTEC TENTS
DESIGN & PRODUCTION
2685 COLUMBIA ST. TORRANCE, CA. 90503
(800) 228-3687 - FAX (310) 381-0722

TIDEWATER POLE TENT
32'W x 40'L - 10' BAY
TIDEWATER SAIL CLOTH POLE TENT
PART NUMBER: ZXXXXXX

REVISION HISTORY			
REV.	DESCRIPTION	BY:	DATE:
PROPRIETARY			
ENGINEER: N/A		DATE: 12/05/2024	
PAGE: 1 OF 1		DRAWN: M.CARDENAS	

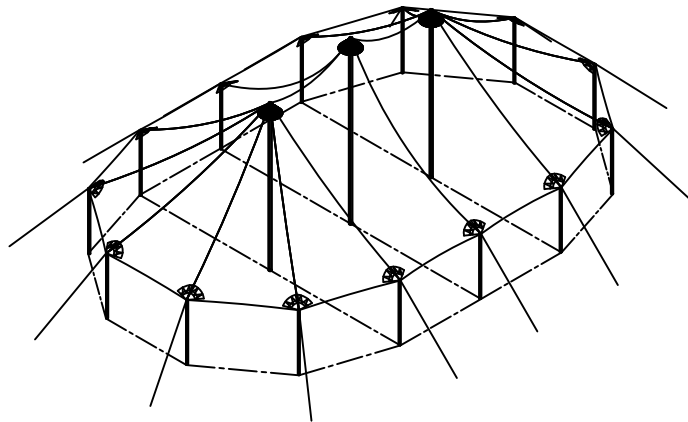

ISOMETRIC VIEW
1417 SQ. FT

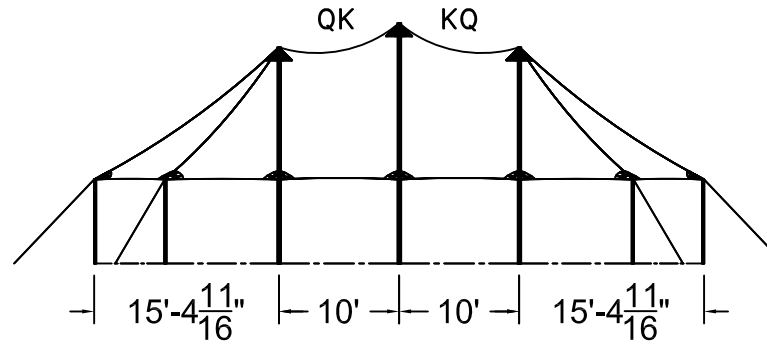

SIDE VIEW

32'W x 50'L TIDEWATER SAIL CLOTH POLE TENT

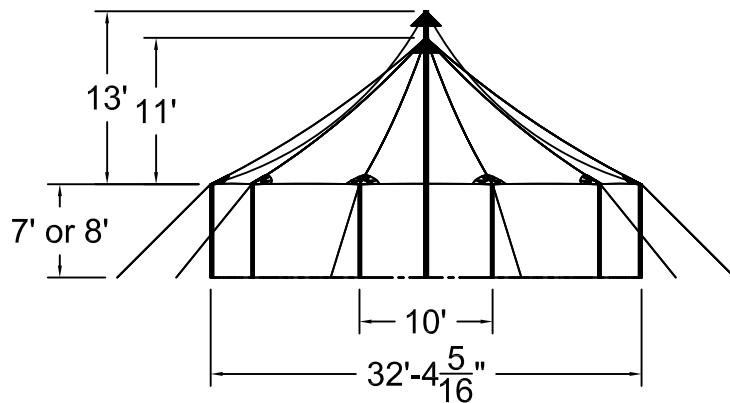

32'W TW FRONT END

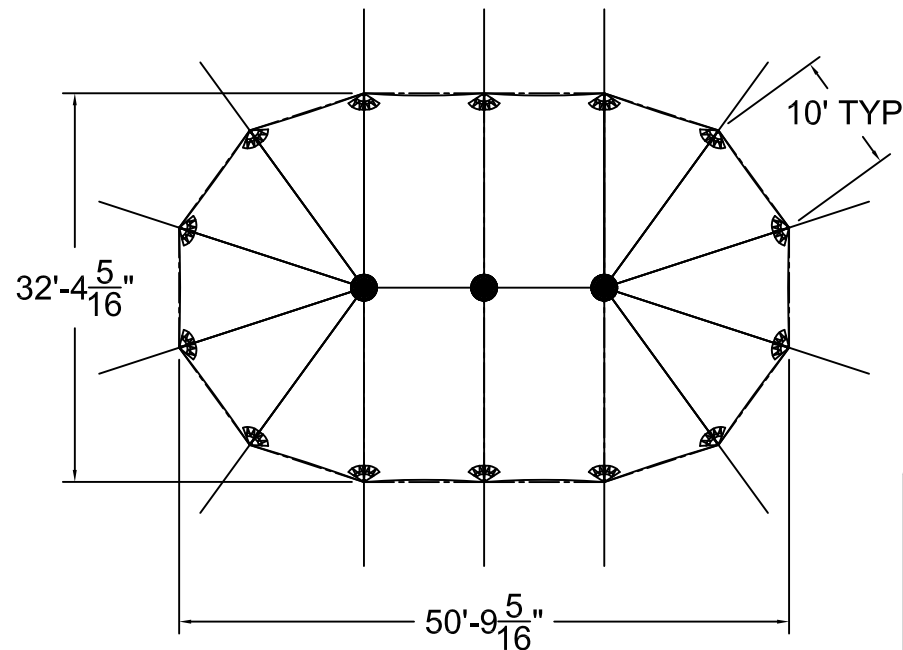

TOP VIEW

ALL DATA AND INFORMATION CONTAINED IN OR DISCLOSED BY THIS DOCUMENT IS CONFIDENTIAL AND PROPRIETARY INFORMATION OF AZTEC TENTS AND ALL RIGHTS THEREIN ARE EXPRESSLY RESERVED. BY ACCEPTING THIS MATERIAL THE RECIPIENT AGREES THAT THIS MATERIAL AND INFORMATION CONTAINED THEREIN IS HELD IN CONFIDENCE AND IN TRUST AND WILL NOT BE COPIED, REPRODUCED WHOLE OR IN PART NOR ITS CONTENTS REVEALED IN ANY MANNER TO OTHERS, EXCEPT TO MEET THE SPECIFIC PURPOSE FOR WHICH IT WAS DELIVERED.

AZTEC TENTS
DESIGN & PRODUCTION
2685 COLUMBIA ST. TORRANCE, CA. 90503
(800) 228-3687 - FAX (310) 381-0722

TIDEWATER POLE TENT
32'W x 50'L - 10' BAYS
TIDEWATER SAIL CLOTH POLE TENT
PART NUMBER: ZXXXXXX

REVISION HISTORY			
REV.	DESCRIPTION	BY:	DATE:
PROPRIETARY			
ENGINEER: N/A		DATE: 12/05/2024	
PAGE: 1 OF 1		DRAWN: M.CARDENAS	

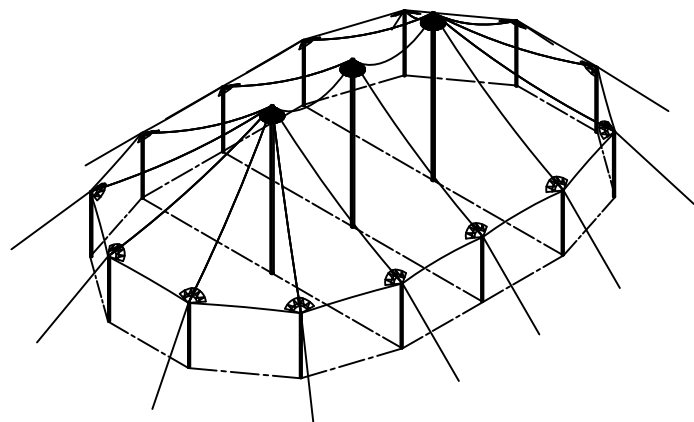

ISOMETRIC VIEW
1417 SQ. FT

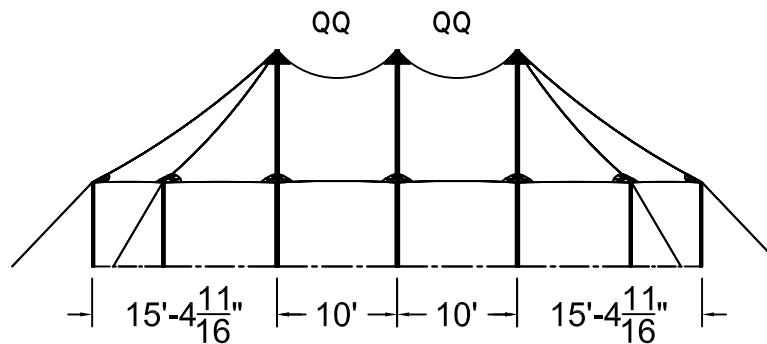

SIDE VIEW

32'W x 50'L TIDEWATER SAIL CLOTH POLE TENT

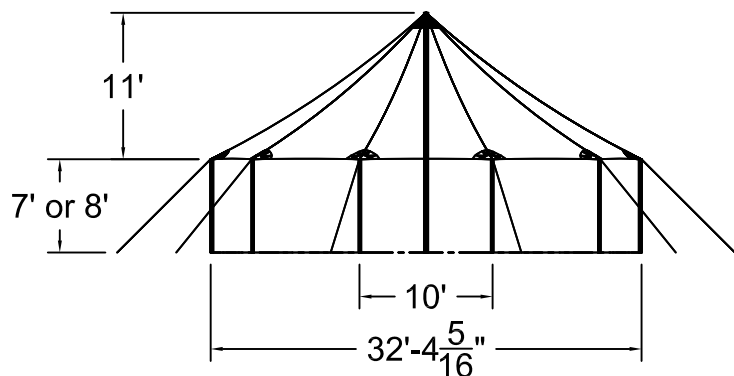

32'W TW FRONT END

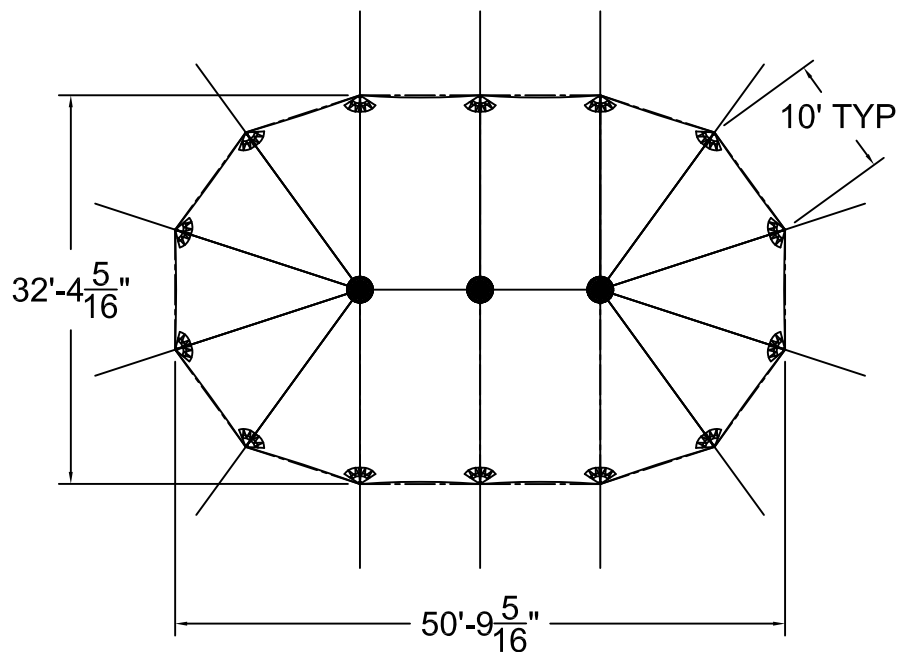

TOP VIEW



DESIGN & PRODUCTION
2685 COLUMBIA ST. TORRANCE, CA. 90503
(800) 228-3687 - FAX (310) 381-0722

TIDEWATER POLE TENT

32'W x 50'L - 10' BAYS

TIDEWATER SAIL CLOTH POLE TENT

PART NUMBER: ZXXXXXX

REVISION HISTORY

REV.	DESCRIPTION	BY:	DATE:

PROPRIETARY

ENGINEER:	DATE:
N/A	12/05/2024
PAGE:	DRAWN:
1 OF 1	M. CARDENAS

ALL DATA AND INFORMATION CONTAINED IN OR DISCLOSED BY THIS DOCUMENT IS CONFIDENTIAL AND PROPRIETARY INFORMATION OF AZTEC TENTS AND ALL RIGHTS THEREIN ARE EXPRESSLY RESERVED. BY ACCEPTING THIS MATERIAL THE RECIPIENT AGREES THAT THIS MATERIAL AND INFORMATION CONTAINED THEREIN IS HELD IN CONFIDENCE AND IN TRUST AND WILL NOT BE COPIED, REPRODUCED WHOLE OR IN PART NOR ITS CONTENTS REVEALED IN ANY MANNER TO OTHERS, EXCEPT TO MEET THE SPECIFIC PURPOSE FOR WHICH IT WAS DELIVERED.

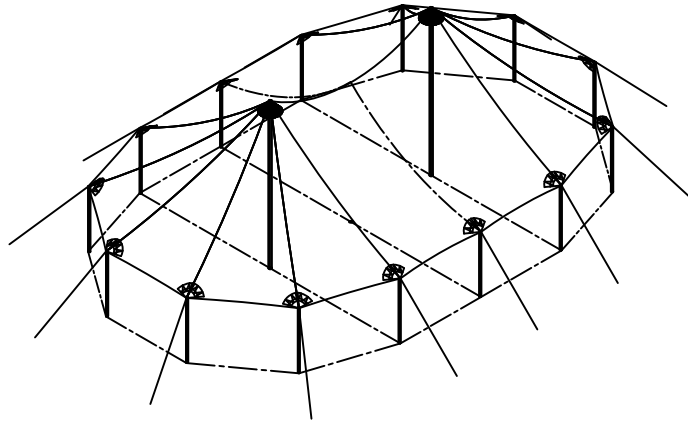

ISOMETRIC VIEW

1417 SQ. FT

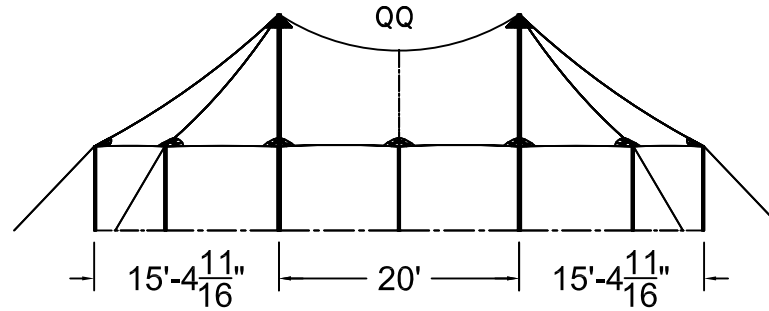

SIDE VIEW

32'W x 50'L TIDEWATER SAIL CLOTH POLE TENT

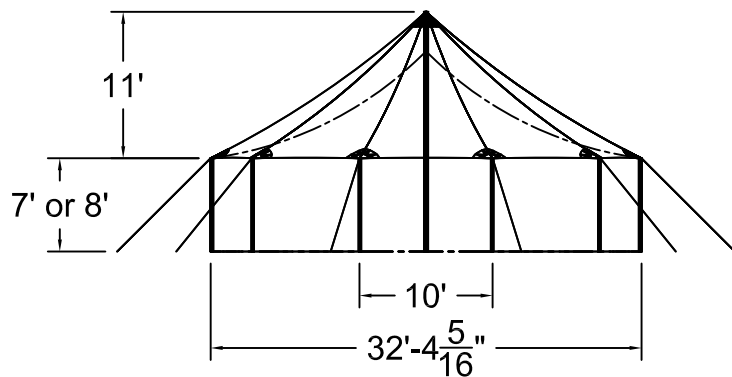

32'W TW FRONT END

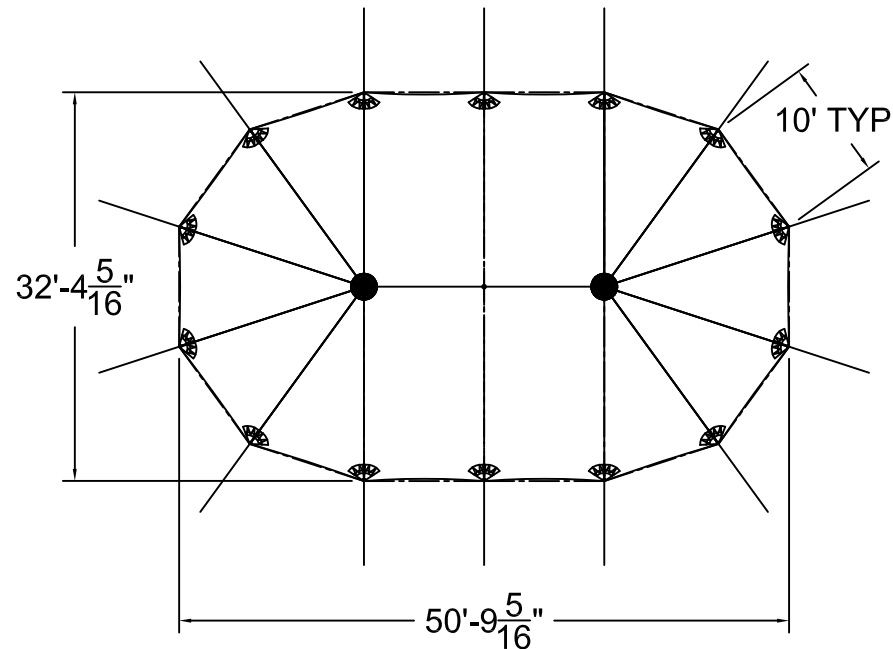

TOP VIEW

ALL DATA AND INFORMATION CONTAINED IN OR DISCLOSED BY THIS DOCUMENT IS CONFIDENTIAL AND PROPRIETARY INFORMATION OF AZTEC TENTS AND ALL RIGHTS THEREIN ARE EXPRESSLY RESERVED. BY ACCEPTING THIS MATERIAL THE RECIPIENT AGREES THAT THIS MATERIAL AND INFORMATION CONTAINED THEREIN IS HELD IN CONFIDENCE AND IN TRUST AND WILL NOT BE COPIED, REPRODUCED WHOLE OR IN PART NOR ITS CONTENTS REVEALED IN ANY MANNER TO OTHERS, EXCEPT TO MEET THE SPECIFIC PURPOSE FOR WHICH IT WAS DELIVERED.

AZTEC TENTS
DESIGN & PRODUCTION
2685 COLUMBIA ST. TORRANCE, CA. 90503
(800) 228-3687 - FAX (310) 381-0722

TIDEWATER POLE TENT
32'W x 50'L - 20' BAY
TIDEWATER SAIL CLOTH POLE TENT
PART NUMBER: ZXXXXXX

REVISION HISTORY			
REV.	DESCRIPTION	BY	DATE
PROPRIETARY			
ENGINEER: N/A		DATE: 12/05/2024	
PAGE: 1 OF 1		DRAWN: M.CARDENAS	

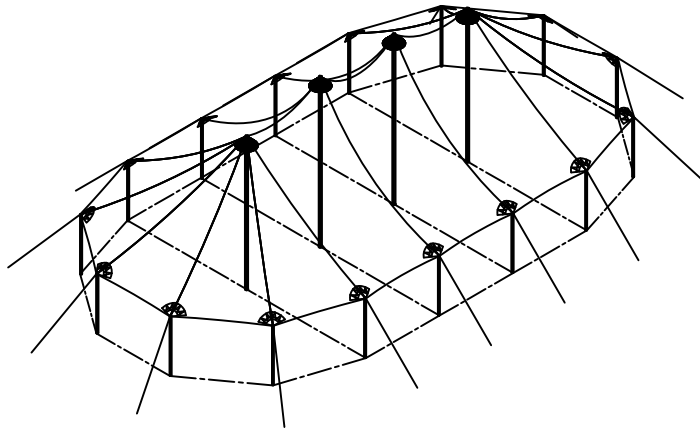

ISOMETRIC VIEW

1740 SQ. FT

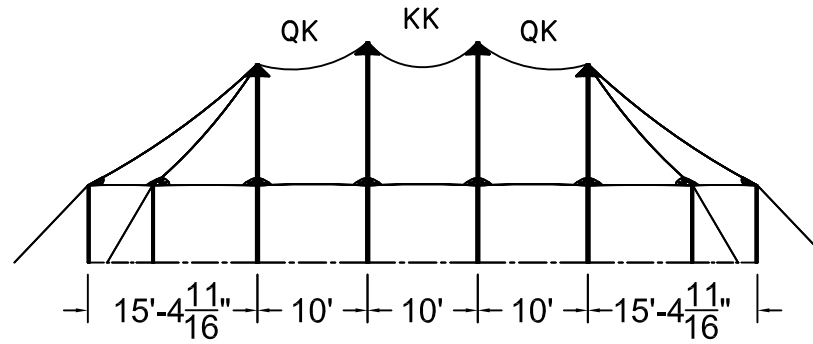

SIDE VIEW

32'W x 60'L TIDEWATER SAIL CLOTH POLE TENT

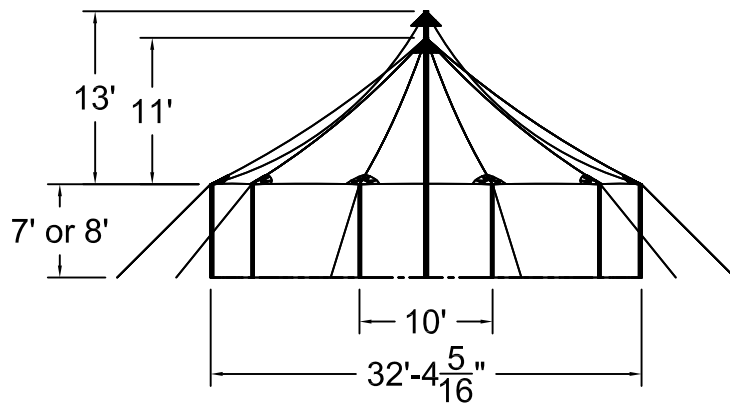

32'W TW FRONT END

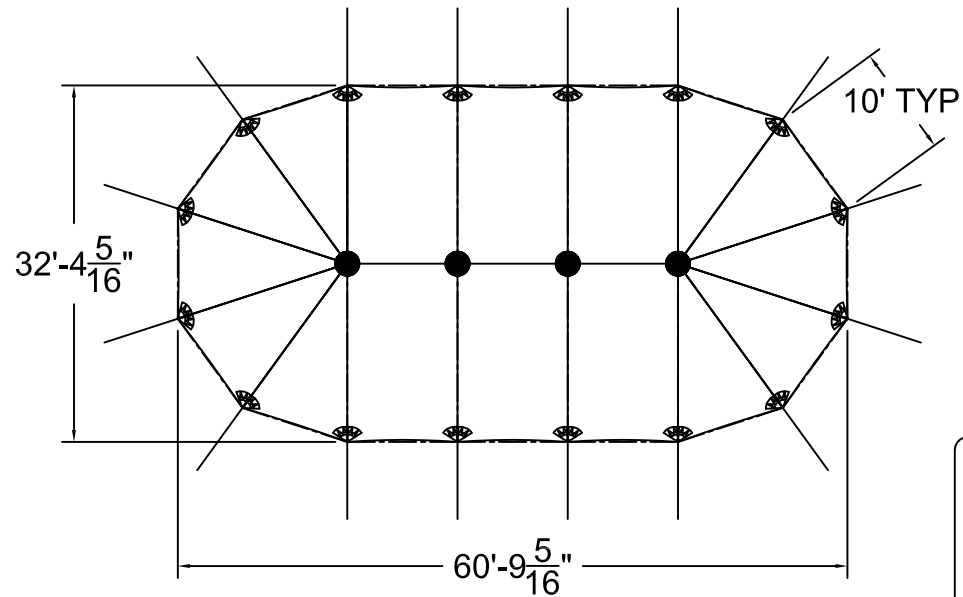

TOP VIEW

ALL DATA AND INFORMATION CONTAINED IN OR DISCLOSED BY THIS DOCUMENT IS CONFIDENTIAL AND PROPRIETARY INFORMATION OF AZTEC TENTS AND ALL RIGHTS THEREIN ARE EXPRESSLY RESERVED. BY ACCEPTING THIS MATERIAL THE RECIPIENT AGREES THAT THIS MATERIAL AND INFORMATION CONTAINED THEREIN IS HELD IN CONFIDENCE AND IN TRUST AND WILL NOT BE COPIED, REPRODUCED WHOLE OR IN PART, NOR ITS CONTENTS REVEALED IN ANY MANNER TO OTHERS, EXCEPT TO MEET THE SPECIFIC PURPOSE FOR WHICH IT WAS DELIVERED.

AZTEC TENTS
DESIGN & PRODUCTION
2685 COLUMBIA ST. TORRANCE, CA. 90503
(800) 228-3687 - FAX (310) 381-0722

TIDEWATER POLE TENT
32'W x 60'L - 10' BAY
TIDEWATER SAIL CLOTH POLE TENT
PART NUMBER: ZXXXXXX

REVISION HISTORY			
REV.	DESCRIPTION	BY	DATE
PROPRIETARY			
ENGINEER: N/A		DATE: 12/05/2024	
PAGE: 1 OF 1		DRAWN: M.CARDENAS	

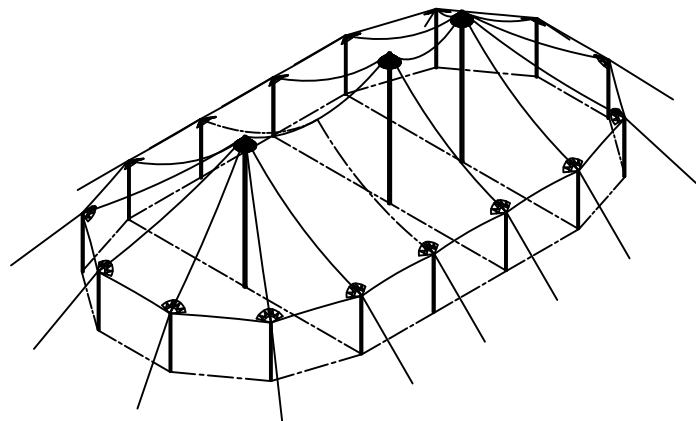

ISOMETRIC VIEW

1740 SQ. FT

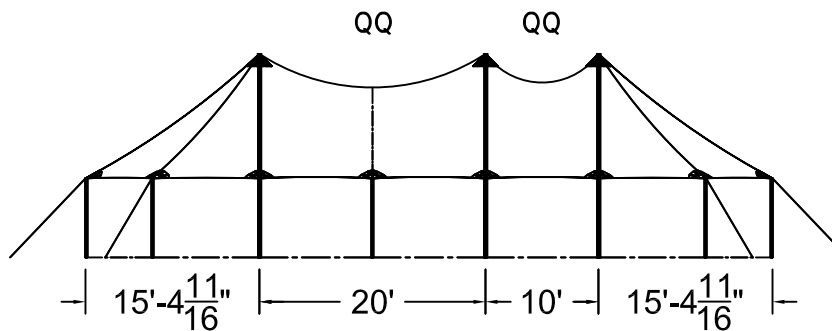

SIDE VIEW

32'W x 60'L TIDEWATER SAIL CLOTH POLE TENT

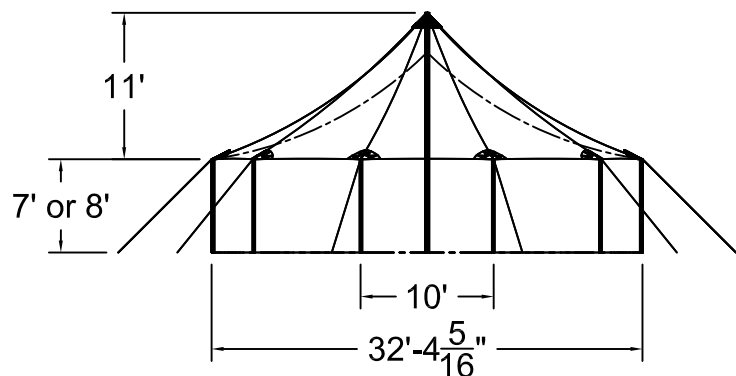

32'W TW FRONT END

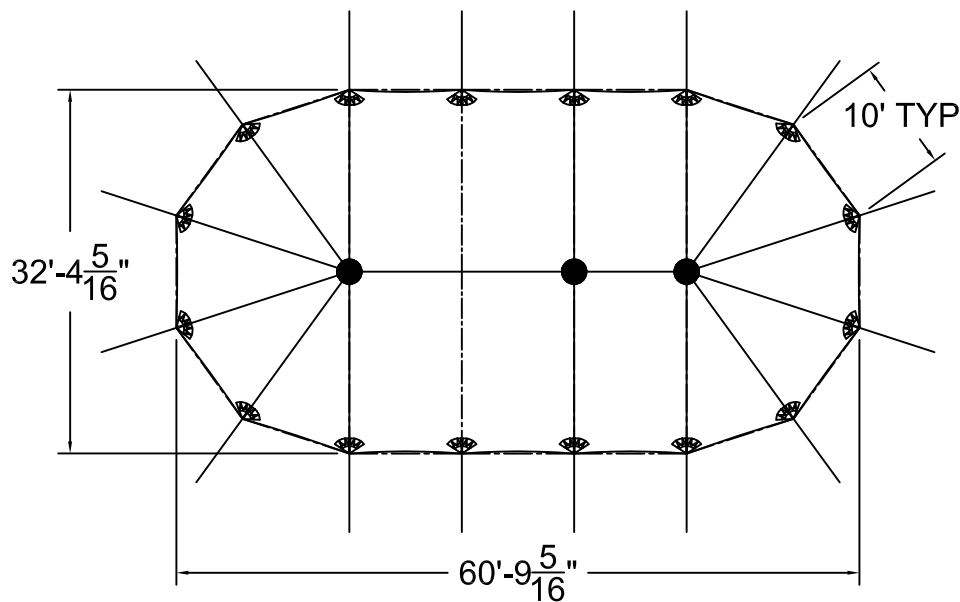

TOP VIEW

ALL DATA AND INFORMATION CONTAINED IN OR DISCLOSED BY THIS DOCUMENT IS CONFIDENTIAL AND PROPRIETARY INFORMATION OF AZTEC TENTS AND ALL RIGHTS THEREIN ARE EXPRESSLY RESERVED. BY ACCEPTING THIS MATERIAL THE RECIPIENT AGREES THAT THIS MATERIAL AND INFORMATION CONTAINED HEREIN IS HELD IN CONFIDENCE AND IN TRUST AND WILL NOT BE COPIED, REPRODUCED WHOLE OR IN PART, NOR ITS CONTENTS REVEALED IN ANY MANNER TO OTHERS, EXCEPT TO MEET THE SPECIFIC PURPOSE FOR WHICH IT WAS DELIVERED.

AZTEC TENTS
DESIGN & PRODUCTION
2685 COLUMBIA ST. TORRANCE, CA. 90503
(800) 228-3687 - FAX (310) 381-0722

TIDEWATER POLE TENT
32'W x 60'L x 10'-20' BAYS
TIDEWATER SAIL CLOTH POLE TENT
PART NUMBER: ZXXXXXX

REVISION HISTORY			
REV.	DESCRIPTION	BY:	DATE:
PROPRIETARY			
ENGINEER: N/A		DATE: 12/05/2024	
PAGE: 1 OF 1		DRAWN: M.CARDENAS	

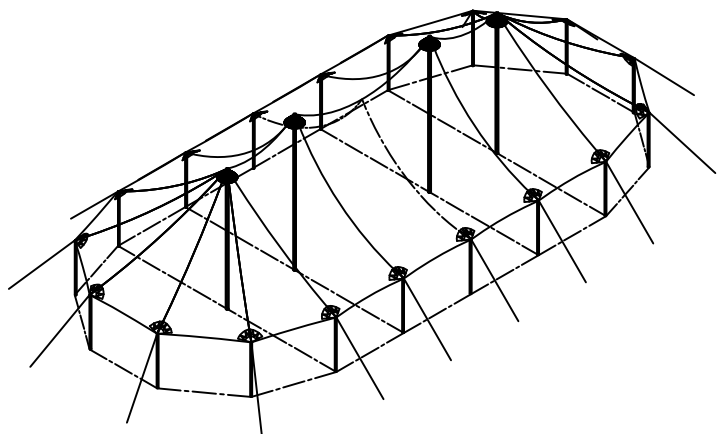

ISOMETRIC VIEW
2064 SQ. FT

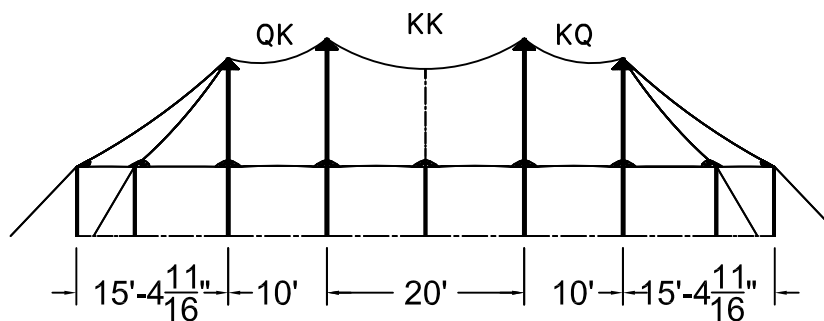

SIDE VIEW

32'W x 70'L TIDEWATER SAIL CLOTH POLE TENT

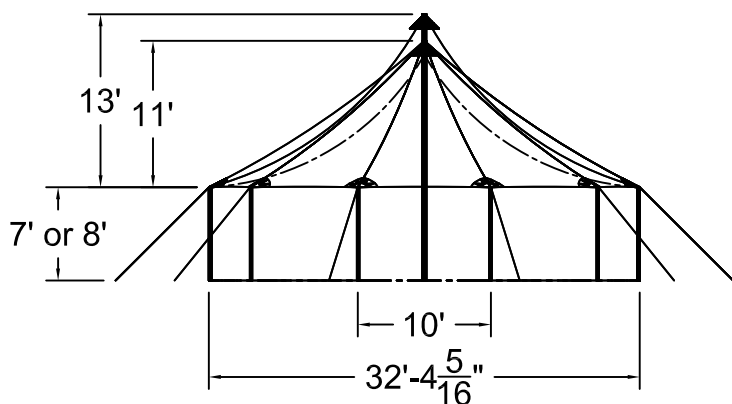

32'W TW FRONT END

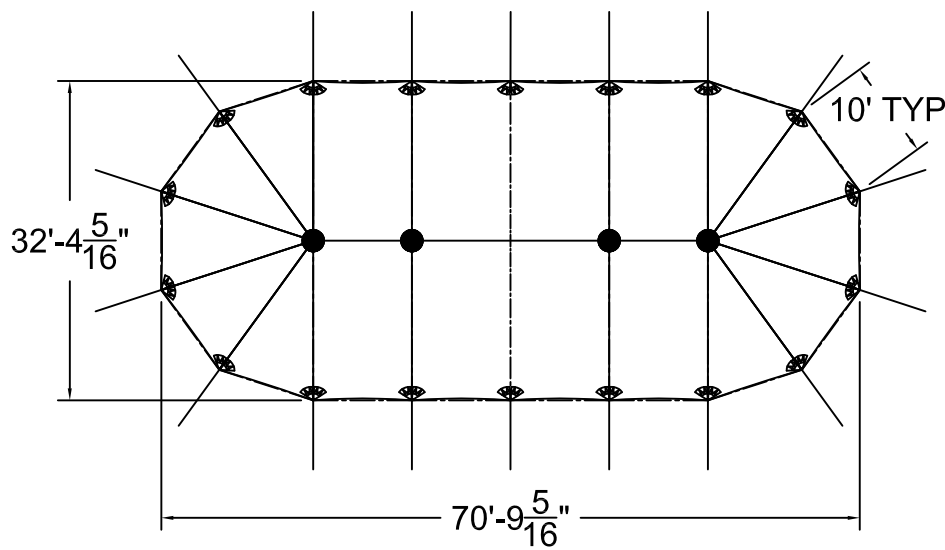

TOP VIEW

ALL DATA AND INFORMATION CONTAINED IN OR DISCLOSED BY THIS DOCUMENT IS CONFIDENTIAL AND PROPRIETARY INFORMATION OF AZTEC TENTS AND ALL RIGHTS THEREIN ARE EXPRESSLY RESERVED. BY ACCEPTING THIS MATERIAL THE RECIPIENT AGREES THAT THIS MATERIAL AND INFORMATION CONTAINED THEREIN IS HELD IN CONFIDENCE AND IN TRUST AND WILL NOT BE COPIED, REPRODUCED WHOLE OR IN PART, NOR ITS CONTENTS REVEALED IN ANY MANNER TO OTHERS, EXCEPT TO MEET THE SPECIFIC PURPOSE FOR WHICH IT WAS DELIVERED.

AZTEC TENTS
DESIGN & PRODUCTION
2685 COLUMBIA ST. TORRANCE, CA. 90503
(800) 228-3687 - FAX (310) 381-0722

TIDEWATER POLE TENT
32'W x 70'L x 10'-20' BAYS
TIDEWATER SAIL CLOTH POLE TENT
PART NUMBER: ZXXXXXX

REVISION HISTORY			
REV.	DESCRIPTION	BY	DATE
PROPRIETARY			
ENGINEER: N/A		DATE: 12/05/2024	
PAGE: 1 OF 1		DRAWN: M.CARDENAS	

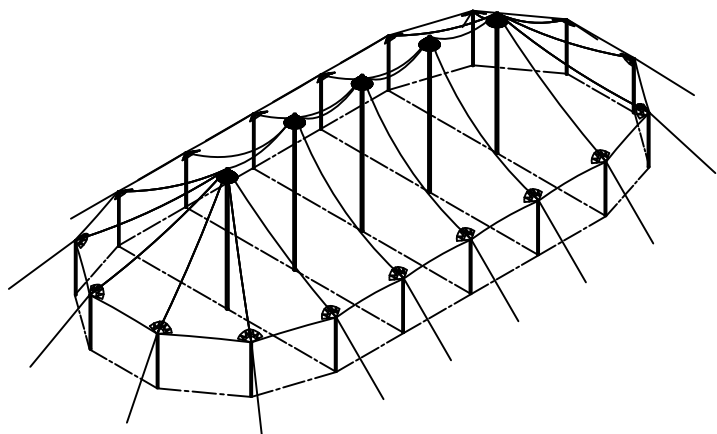

ISOMETRIC VIEW
2064 SQ. FT

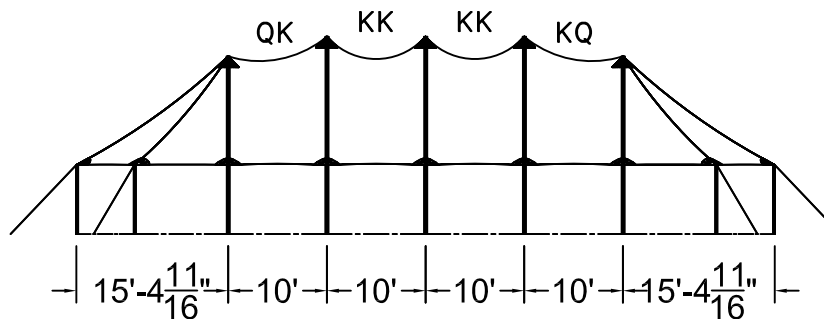

SIDE VIEW

32'W x 70'L TIDEWATER SAIL CLOTH POLE TENT

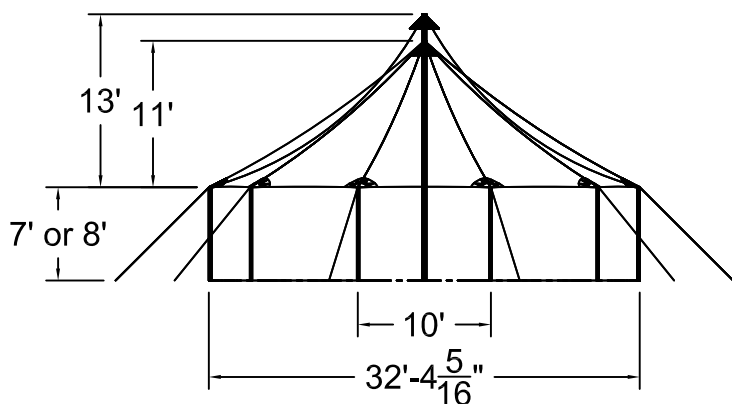

32'W TW FRONT END

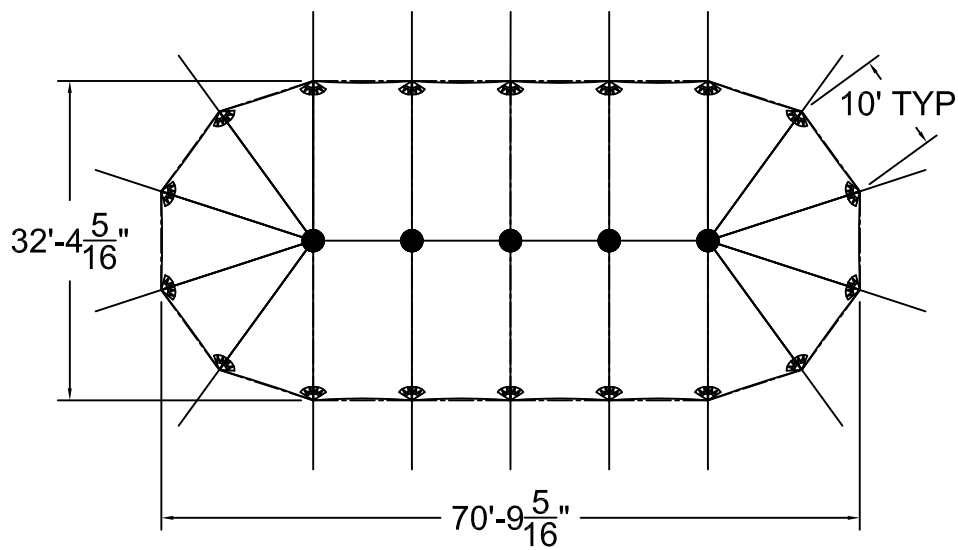

TOP VIEW

ALL DATA AND INFORMATION CONTAINED IN OR DISCLOSED BY THIS DOCUMENT IS CONFIDENTIAL AND PROPRIETARY INFORMATION OF AZTEC TENTS AND ALL RIGHTS THEREIN ARE EXPRESSLY RESERVED. BY ACCEPTING THIS MATERIAL THE RECIPIENT AGREES THAT THIS MATERIAL AND INFORMATION CONTAINED THEREIN IS HELD IN CONFIDENCE AND IN TRUST AND WILL NOT BE COPIED, REPRODUCED WHOLE OR IN PART, NOR ITS CONTENTS REVEALED IN ANY MANNER TO OTHERS, EXCEPT TO MEET THE SPECIFIC PURPOSE FOR WHICH IT WAS DELIVERED.

AZTEC TENTS
DESIGN & PRODUCTION
2685 COLUMBIA ST. TORRANCE, CA. 90503
(800) 228-3687 - FAX (310) 381-0722

TIDEWATER POLE TENT
32'W x 70'L x 10' BAYS
TIDEWATER SAIL CLOTH POLE TENT
PART NUMBER: ZXXXXXX

REVISION HISTORY			
REV.	DESCRIPTION	BY:	DATE:
PROPRIETARY			
ENGINEER: N/A		DATE: 12/05/2024	
PAGE: 1 OF 1		DRAWN: M.CARDENAS	

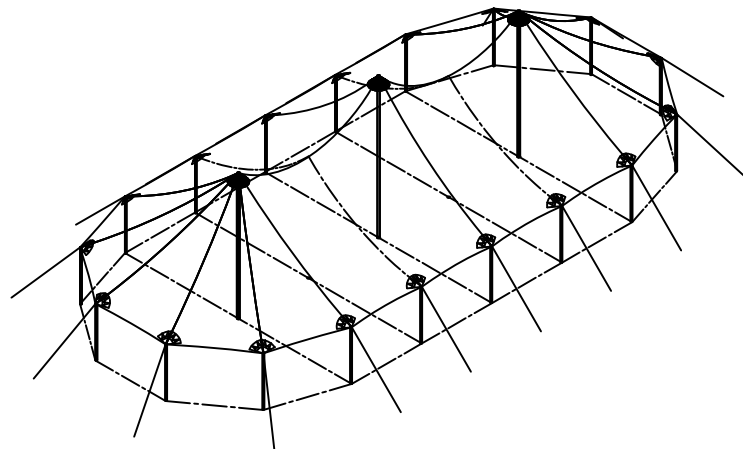

ISOMETRIC VIEW
2064 SQ. FT

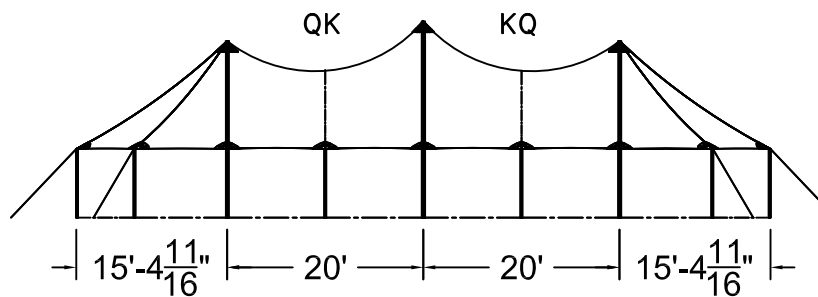

SIDE VIEW

32'W x 70'L TIDEWATER SAIL CLOTH POLE TENT

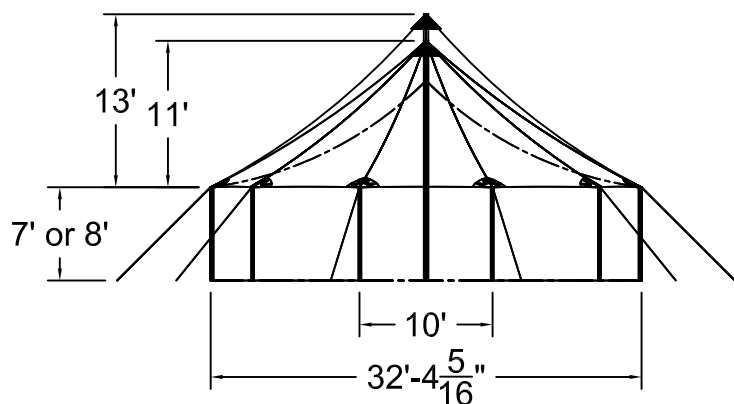

32'W TW FRONT END

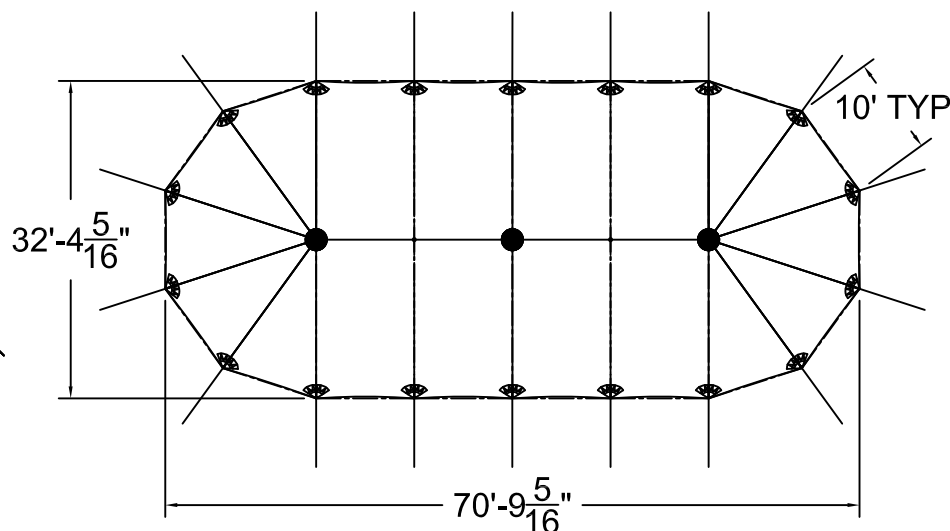

TOP VIEW

ALL DATA AND INFORMATION CONTAINED IN OR DISCLOSED BY THIS DOCUMENT IS CONFIDENTIAL AND PROPRIETARY INFORMATION OF AZTEC TENTS AND ALL RIGHTS THEREIN ARE EXPRESSLY RESERVED. BY ACCEPTING THIS MATERIAL THE RECIPIENT AGREES THAT THIS MATERIAL AND INFORMATION CONTAINED THEREIN IS HELD IN CONFIDENCE AND IN TRUST AND WILL NOT BE COPIED, REPRODUCED WHOLE OR IN PART, NOR ITS CONTENTS REVEALED IN ANY MANNER TO OTHERS, EXCEPT TO MEET THE SPECIFIC PURPOSE FOR WHICH IT WAS DELIVERED.

AZTEC TENTS
DESIGN & PRODUCTION
2685 COLUMBIA ST. TORRANCE, CA. 90503
(800) 228-3687 - FAX (310) 381-0722

TIDEWATER POLE TENT
32'W x 70'L - 20' BAY
TIDEWATER SAIL CLOTH POLE TENT
PART NUMBER: ZXXXXXX

REVISION HISTORY			
REV.	DESCRIPTION	BY	DATE
PROPRIETARY			
ENGINEER: N/A		DATE: 12/05/2024	
PAGE: 1 OF 1		DRAWN: M.CARDENAS	

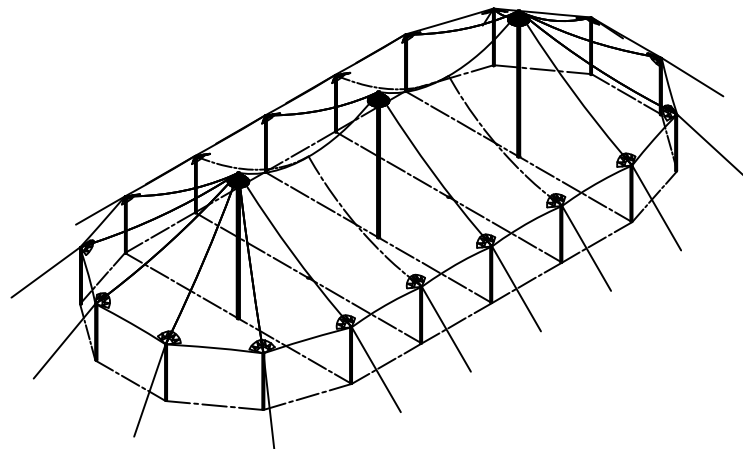

ISOMETRIC VIEW
2064 SQ. FT

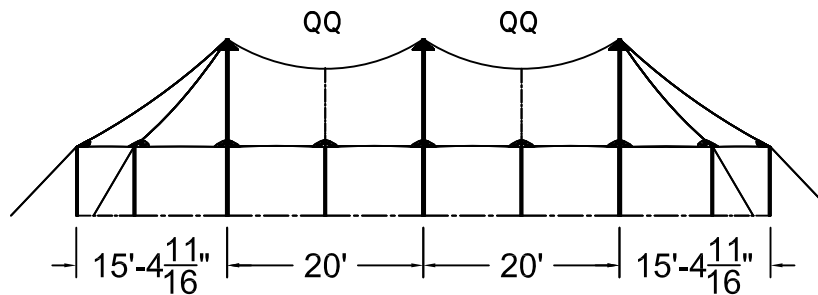

SIDE VIEW

32'W x 70'L TIDEWATER SAIL CLOTH POLE TENT

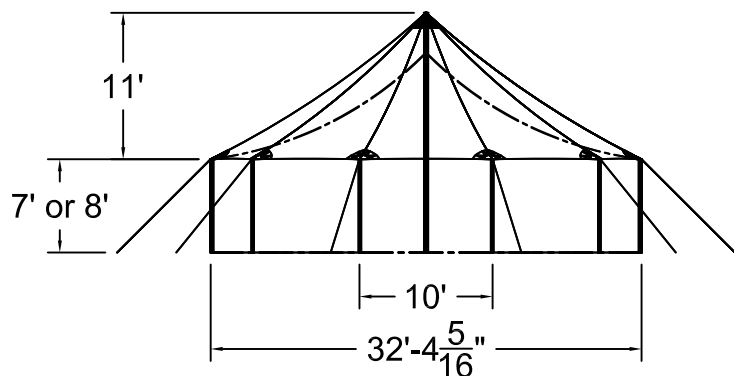

32'W TW FRONT END

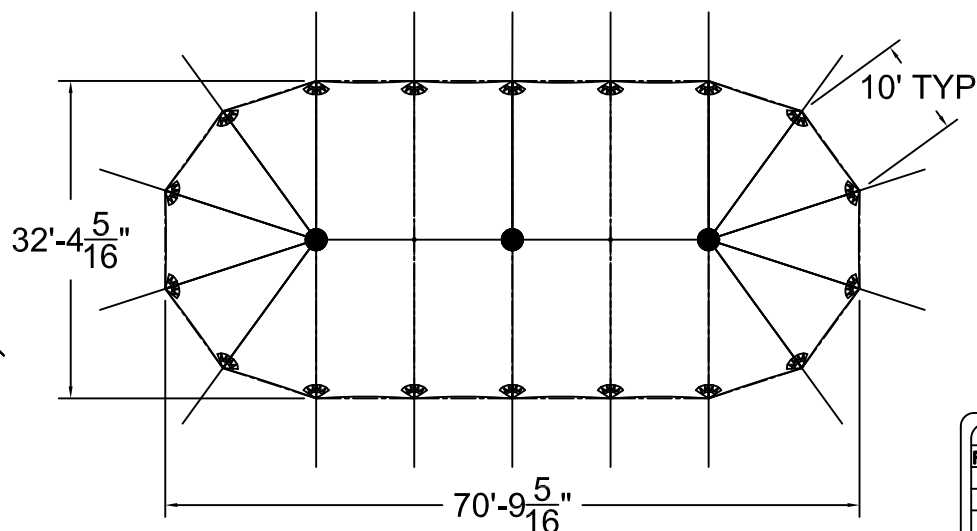

TOP VIEW

ALL DATA AND INFORMATION CONTAINED IN OR DISCLOSED BY THIS DOCUMENT IS CONFIDENTIAL AND PROPRIETARY INFORMATION OF AZTEC TENTS AND ALL RIGHTS THEREIN ARE EXPRESSLY RESERVED. BY ACCEPTING THIS MATERIAL THE RECIPIENT AGREES THAT THIS MATERIAL AND INFORMATION CONTAINED THEREIN IS HELD IN CONFIDENCE AND IN TRUST AND WILL NOT BE COPIED, REPRODUCED WHOLE OR IN PART, NOR ITS CONTENTS REVEALED IN ANY MANNER TO OTHERS, EXCEPT TO MEET THE SPECIFIC PURPOSE FOR WHICH IT WAS DELIVERED.

AZTEC TENTS
DESIGN & PRODUCTION
2685 COLUMBIA ST. TORRANCE, CA. 90503
(800) 228-3687 - FAX (310) 381-0722

TIDEWATER POLE TENT
32'W x 70'L - 20' BAY
TIDEWATER SAIL CLOTH POLE TENT
PART NUMBER: ZXXXXXX

REVISION HISTORY			
REV.	DESCRIPTION	BY	DATE
PROPRIETARY			
ENGINEER: N/A		DATE: 12/05/2024	
PAGE: 1 OF 1		DRAWN: M.CARDENAS	

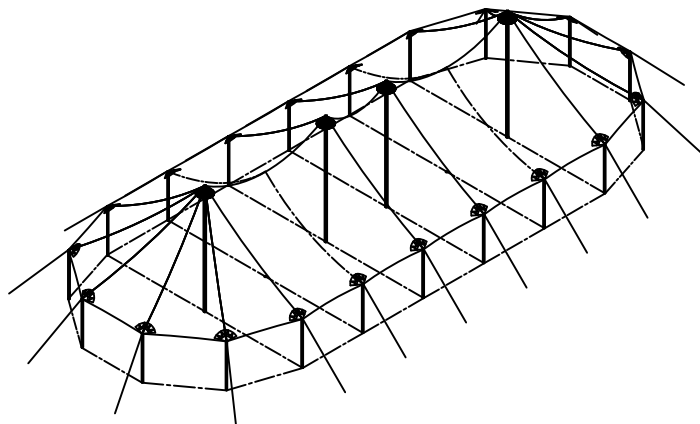

ISOMETRIC VIEW
2387 SQ. FT

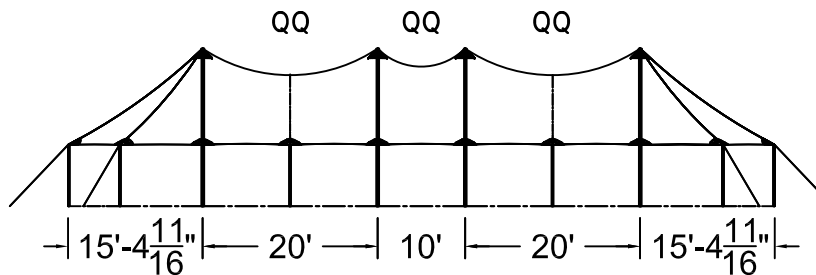

SIDE VIEW

32'W x 80'L TIDEWATER SAIL CLOTH POLE TENT

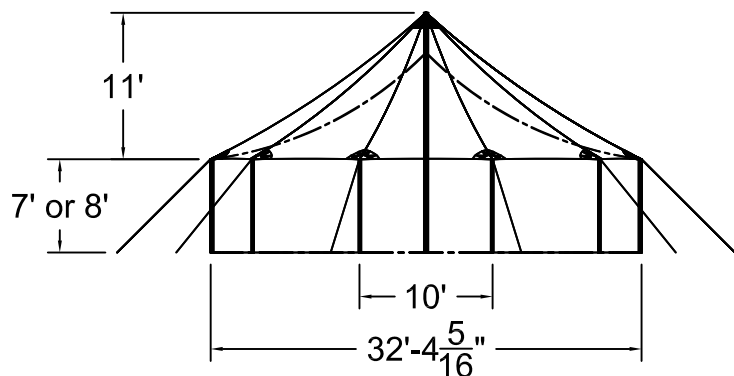

32'W TW FRONT END

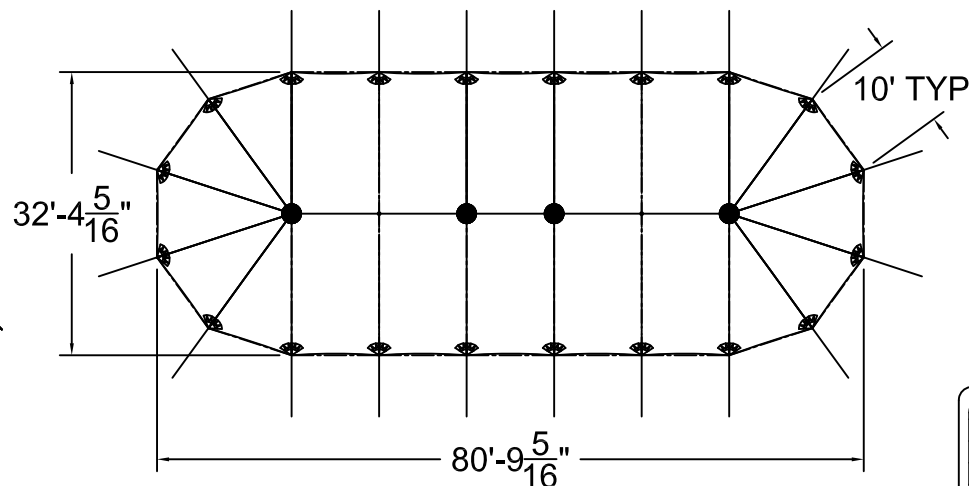

TOP VIEW

ALL DATA AND INFORMATION CONTAINED IN OR DISCLOSED BY THIS DOCUMENT IS CONFIDENTIAL AND PROPRIETARY INFORMATION OF AZTEC TENTS AND ALL RIGHTS THEREIN ARE EXPRESSLY RESERVED. BY ACCEPTING THIS MATERIAL THE RECIPIENT AGREES THAT THIS MATERIAL AND INFORMATION CONTAINED THEREIN IS HELD IN CONFIDENCE AND IN TRUST AND WILL NOT BE COPIED, REPRODUCED WHOLE OR IN PART, NOR ITS CONTENTS REVEALED IN ANY MANNER TO OTHERS, EXCEPT TO MEET THE SPECIFIC PURPOSE FOR WHICH IT WAS DELIVERED.

AZTEC TENTS
DESIGN & PRODUCTION
2685 COLUMBIA ST. TORRANCE, CA. 90503
(800) 228-3687 - FAX (310) 381-0722

TIDEWATER POLE TENT
32'W x 80'L x 10'-20' BAY
TIDEWATER SAIL CLOTH POLE TENT
PART NUMBER: ZXXXXXX

REVISION HISTORY			
REV.	DESCRIPTION	BY	DATE
PROPRIETARY			
ENGINEER: N/A		DATE: 12/05/2024	
PAGE: 1 OF 1		DRAWN: M.CARDENAS	

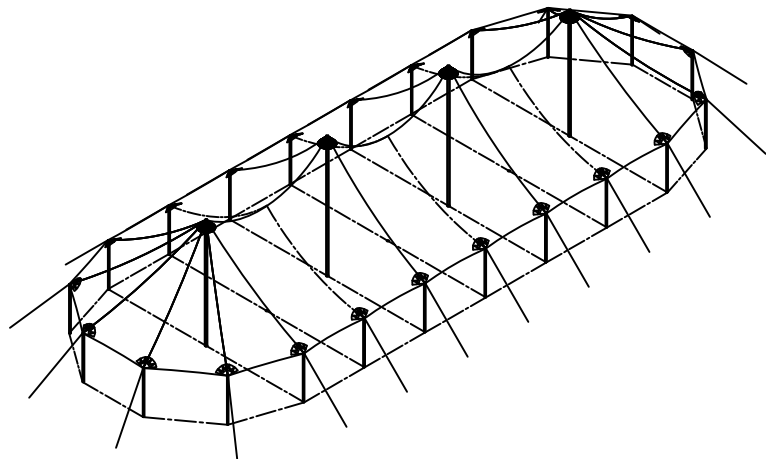

ISOMETRIC VIEW

2711 SQ. FT

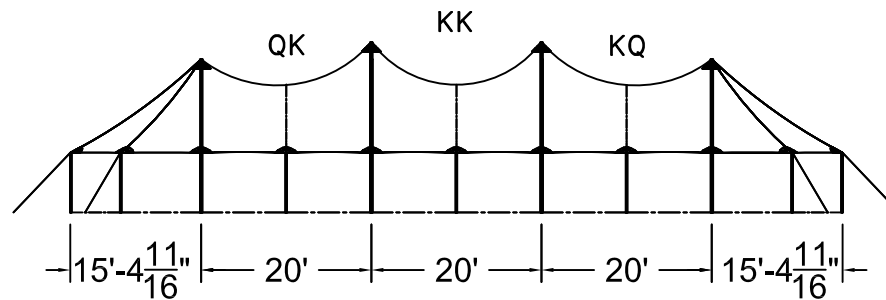

SIDE VIEW

32'W x 90'L TIDEWATER SAIL CLOTH POLE TENT

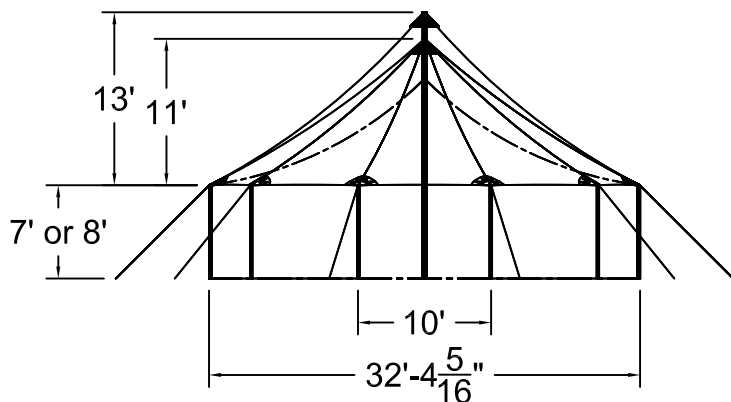

32'W TW FRONT END

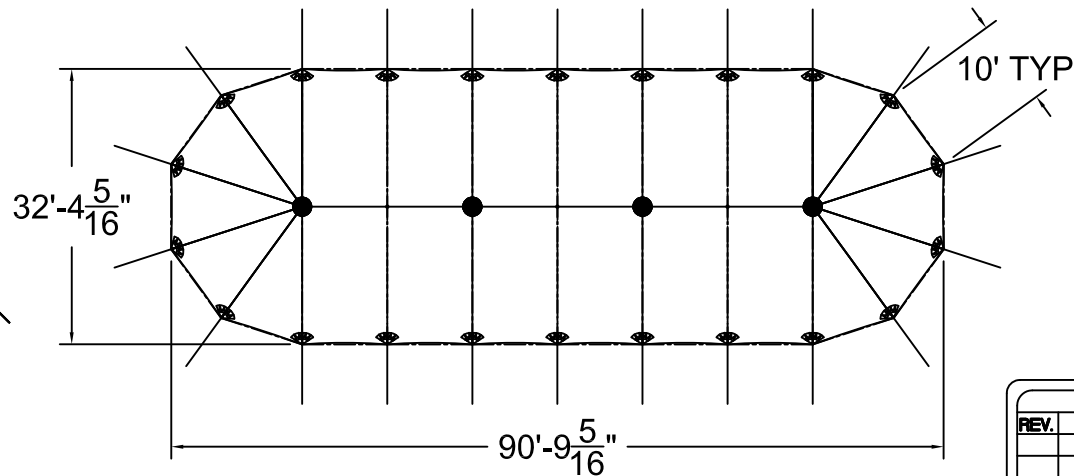

TOP VIEW

ALL DATA AND INFORMATION CONTAINED IN OR DISCLOSED BY THIS DOCUMENT IS CONFIDENTIAL AND PROPRIETARY INFORMATION OF AZTEC TENTS AND ALL RIGHTS THEREIN ARE EXPRESSLY RESERVED. BY ACCEPTING THIS MATERIAL THE RECIPIENT AGREES THAT THIS MATERIAL AND INFORMATION CONTAINED THEREIN IS HELD IN CONFIDENCE AND IN TRUST AND WILL NOT BE COPIED, REPRODUCED WHOLE OR IN PART, NOR ITS CONTENTS REVEALED IN ANY MANNER TO OTHERS, EXCEPT TO MEET THE SPECIFIC PURPOSE FOR WHICH IT WAS DELIVERED.



2685 COLUMBIA ST. TORRANCE, CA. 90503
(800) 228-3687 - FAX (310) 381-0722

TIDEWATER POLE TENT

32'W x 90'L - 20' BAY
TIDEWATER SAIL CLOTH POLE TENT

PART NUMBER: ZXXXXXX

REVISION HISTORY

REV.	DESCRIPTION	BY:	DATE:

PROPRIETARY

ENGINEER:	DATE:
N/A	12/05/2024
PAGE:	DRAWN:
1 OF 1	M. CARDENAS

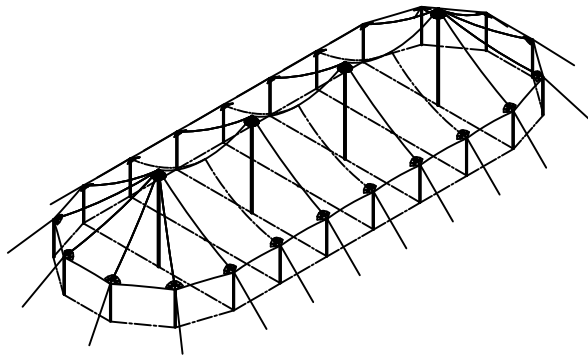

ISOMETRIC VIEW

2711 SQ. FT

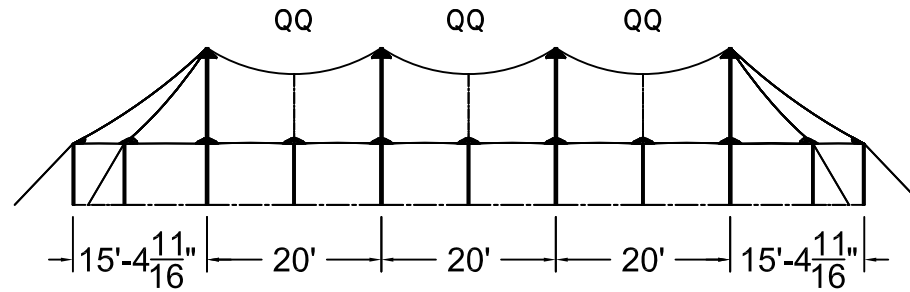

SIDE VIEW

32'W x 90'L TIDEWATER SAIL CLOTH POLE TENT

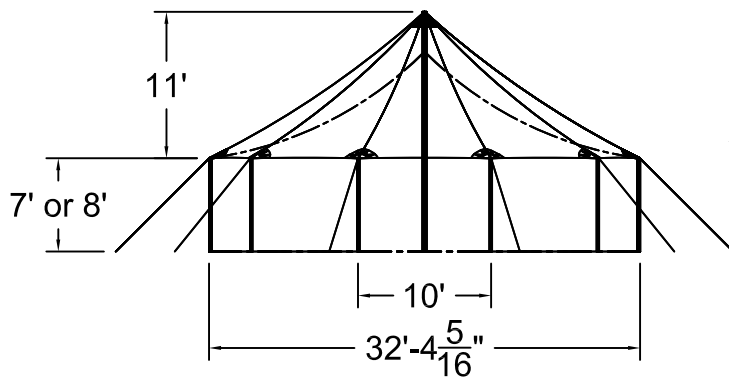

32'W TW FRONT END

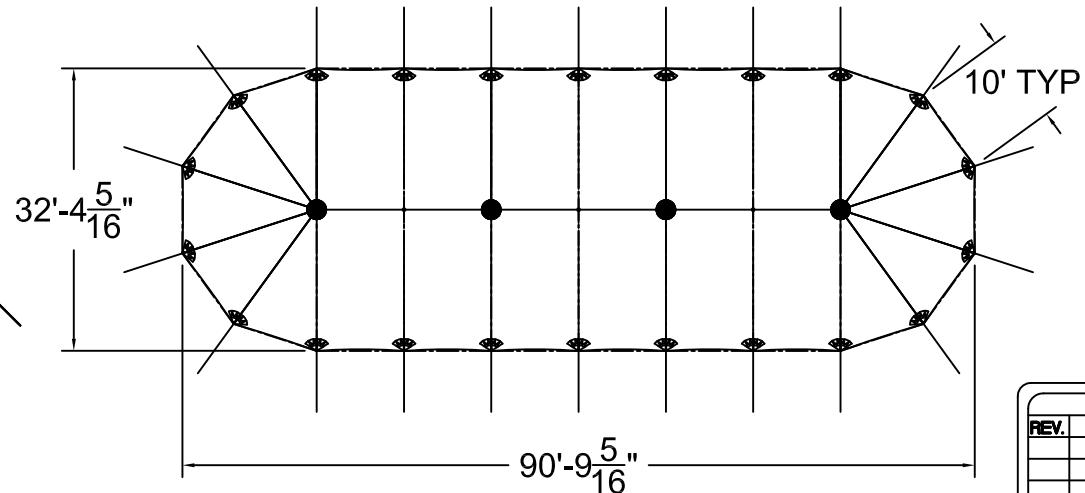

TOP VIEW

ALL DATA AND INFORMATION CONTAINED IN OR DISCLOSED BY THIS DOCUMENT IS CONFIDENTIAL AND PROPRIETARY INFORMATION OF AZTEC TENTS AND ALL RIGHTS THEREIN ARE EXPRESSLY RESERVED. BY ACCEPTING THIS MATERIAL THE RECIPIENT AGREES THAT THIS MATERIAL AND INFORMATION CONTAINED THEREIN IS HELD IN CONFIDENCE AND IN TRUST AND WILL NOT BE COPIED, REPRODUCED WHOLE OR IN PART, NOR ITS CONTENTS REVEALED IN ANY MANNER TO OTHERS, EXCEPT TO MEET THE SPECIFIC PURPOSE FOR WHICH IT WAS DELIVERED.



2685 COLUMBIA ST. TORRANCE, CA. 90503
(800) 228-3687 - FAX (310) 381-0722

TIDEWATER POLE TENT

32'W x 90'L - 20' BAY
TIDEWATER SAIL CLOTH POLE TENT

PART NUMBER: ZXXXXXX

REVISION HISTORY

REV.	DESCRIPTION	BY:	DATE:

PROPRIETARY

ENGINEER: N/A	DATE: 12/05/2024
PAGE: 1 OF 1	DRAWN: M.CARDENAS

32x TIDEWATER SQUARING DIAGRAM

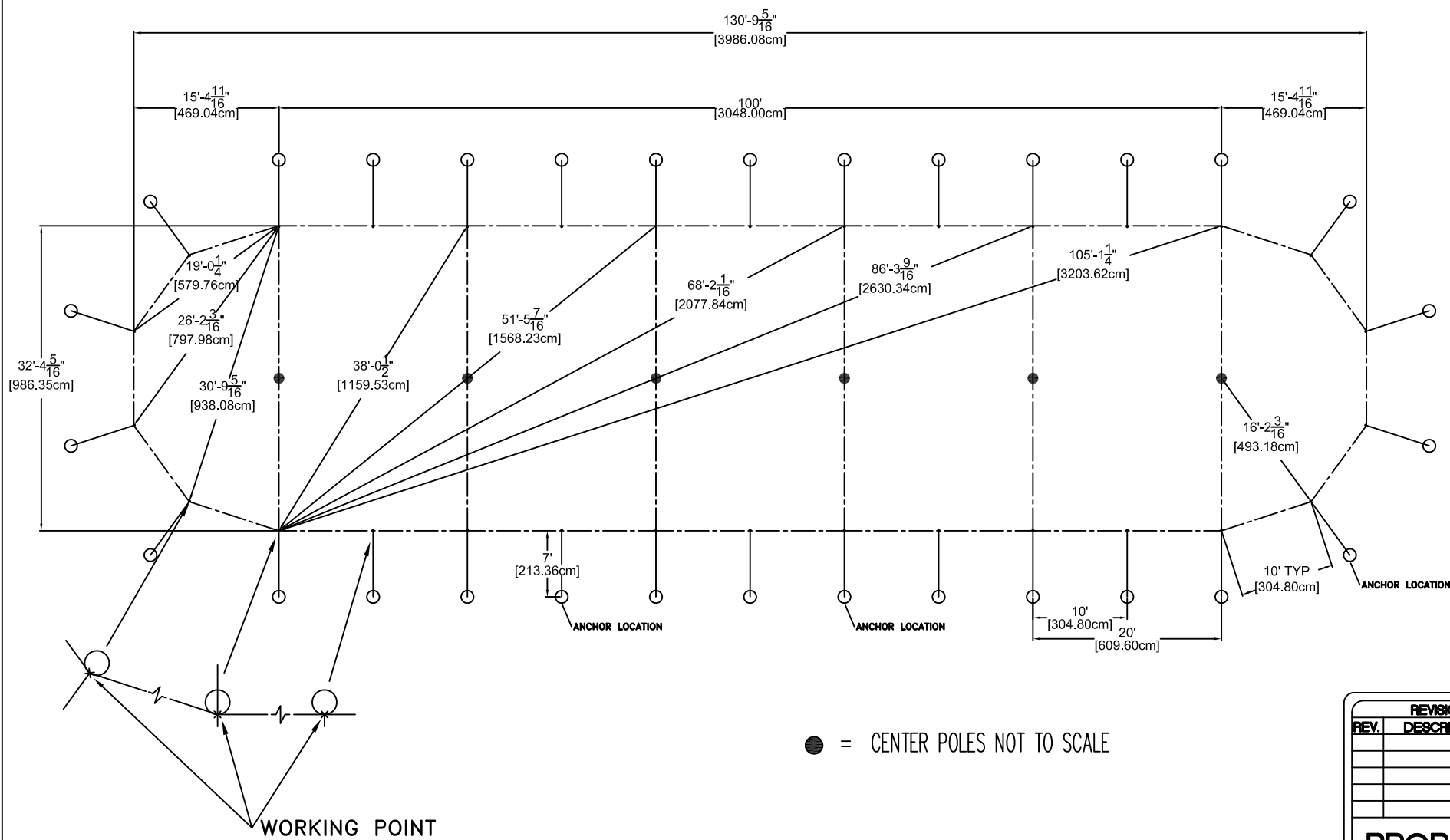

ALL DATA AND INFORMATION CONTAINED IN OR DISCLOSED BY THIS DOCUMENT IS CONFIDENTIAL AND PROPRIETARY INFORMATION OF AZTEC TENTS AND ALL RIGHTS THEREIN ARE EXPRESSLY RESERVED. BY ACCEPTING THIS MATERIAL THE RECIPIENT AGREES THAT THIS MATERIAL AND INFORMATION CONTAINED THEREIN IS HELD IN CONFIDENCE AND IN TRUST AND WILL NOT BE COPIED, REPRODUCED WHOLE OR IN PART, NOR ITS CONTENTS REVEALED IN ANY MANNER TO OTHERS, EXCEPT TO MEET THE SPECIFIC PURPOSE FOR WHICH IT WAS DELIVERED.

AZTEC TENTS
DESIGN & PRODUCTION
2685 COLUMBIA ST. TORRANCE, CA. 90503
(800) 228-3687 - FAX (310) 381-0722

TIDEWATER POLE TENT
32x TIDEWATER SQUARING DIAGRAM
PART NUMBER: ZXXXXXX

REVISION HISTORY			
REV.	DESCRIPTION	BY	DATE
PROPRIETARY			
ENGINEER: N/A		DATE: 12/16/2024	
PAGE: 1 OF 1		DRAWN: M.CARDENAS	